

Gilford, NH : Residential Property Record Card

[\[Back to Search Results \]](#)

[\[Start a New Search \]](#) [\[Help with Printing \]](#)

Search For Properties

Parcel ID#	Name	Street #	Street Name
<input type="text"/>	<input type="text"/>	<input type="text"/>	<input type="text"/>

Parcel ID#	Card	Map-Block-Lot	Location	Zoning	State Class	Acres
216-075-015	1	CURRENT	22 BAXTER CT	SFR	101 - ONEFAMILY	1.150

Living Units

1

Owner Information

Avery, Charles S & Jane A
 22 Baxter Ct
 Gilford NH 03249

Deed Information

Book/Page: 1421/0376
Deed Date: 1997/06/10

Dwelling Information

Style: Contemporary
Story Height: 2
Attic: None
Basement: Full
Year Built: 1991
Ground Flr Area: 1678
Tot Living Area: 2946
Rooms: 9
Bedrooms: 5
Full Baths: 3
Half Baths: 1

Property Picture



Valuation

Land: \$254,500
Building: \$649,400
Total: \$903,900
Net Assessment: \$903,900

Sales History

Book/Page	Date	Price	Type	Validity
1421/0376	1997/06/01	\$199,000	Land + Bldg	3
n/a	1991/12/01	\$189,900	Land + Bldg	3

Out Building Information

Type	Qty	Year	Size1	Size2	Grade	Cond	Value
Shed-Frame	1	2020	10	16	C	A	2470

Building Sketch

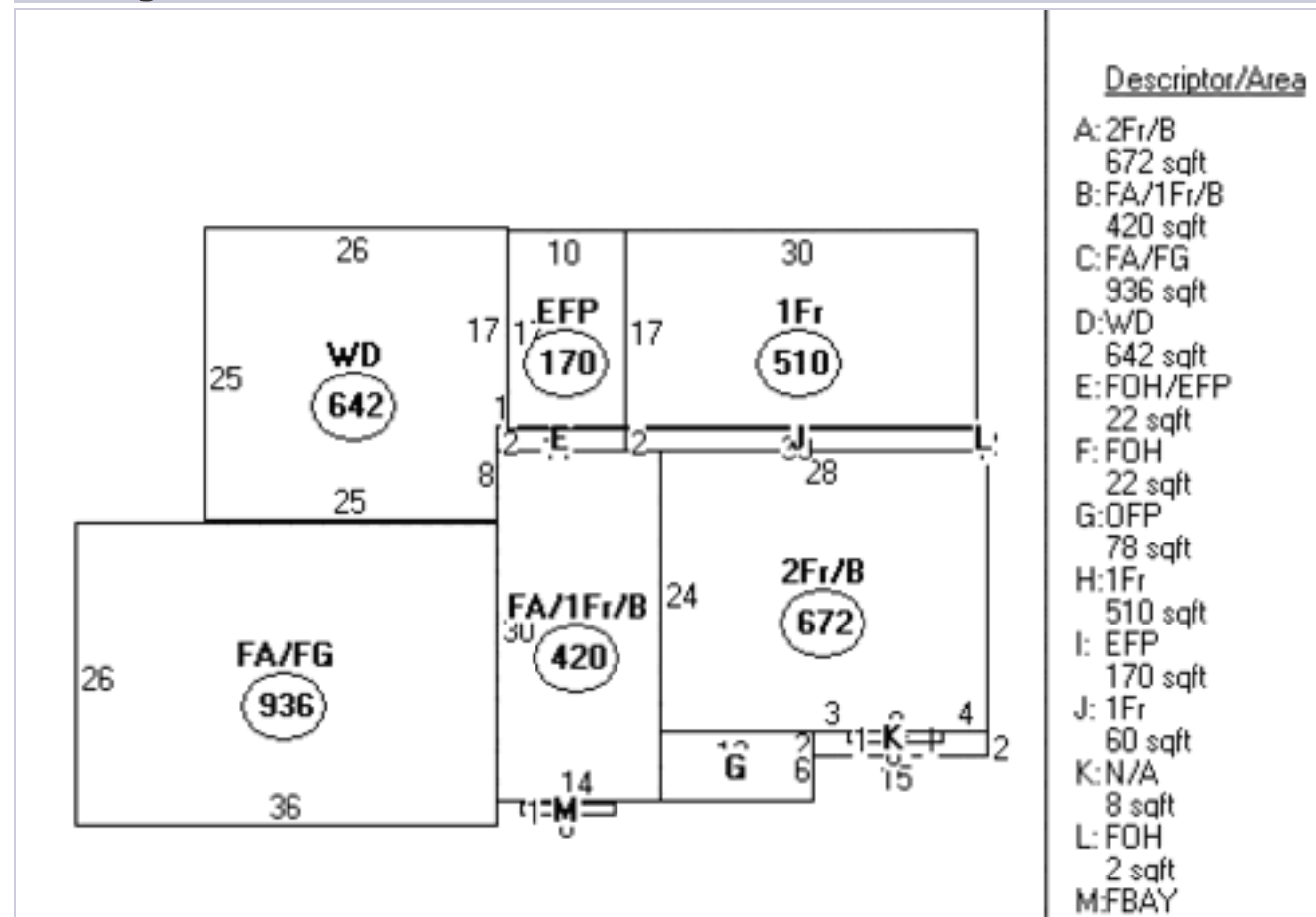

	8 sqft
--	--------

Notice

Tax Year 2023 Values

The information delivered through this on-line database is provided in the spirit of open access to government information and is intended as an enhanced service and convenience for citizens of Gilford, NH.

The providers of this database: CLT, Big Room Studios, and Gilford, NH assume no liability for any error or omission in the information provided here.

Comments regarding this service should be directed to: mmcginley@gilfordnh.org.